

OLD WASHING MOTOR

NEW MOTOR KIT P/N KIT-MOTO (690072402).
The kit includes :a new motor+pressure switch + ground wire

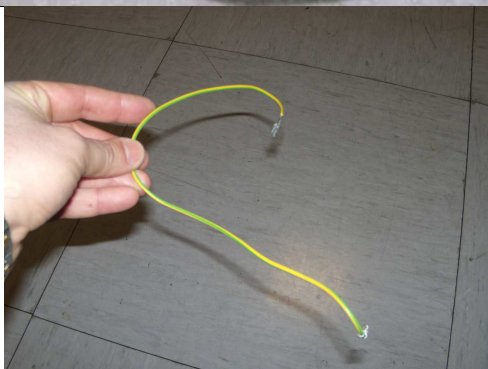

APPLICATION OF THE NEW COMPONENTS TO THE PRE-MODIFICATION APPLIANCES:

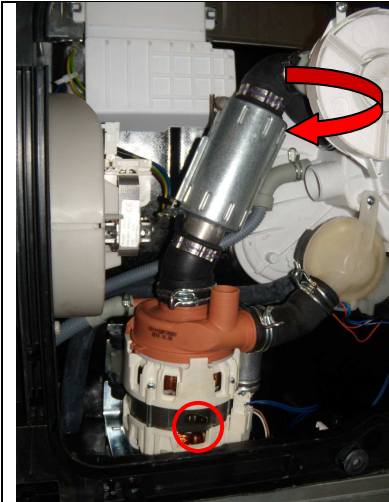

1- Replace the dishwasher's washing pump with the one included in the kit.

2- replace the existing pressure switch with the one included in the kit.

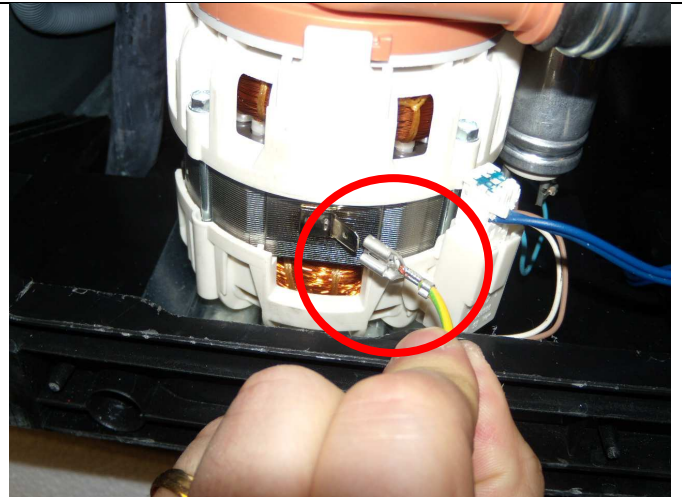
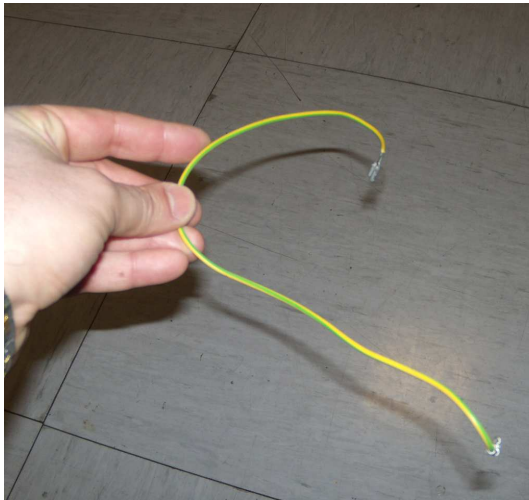

3- Connect one end of the ground cable provided to the pump ground connector and the other to the heating element ground connector

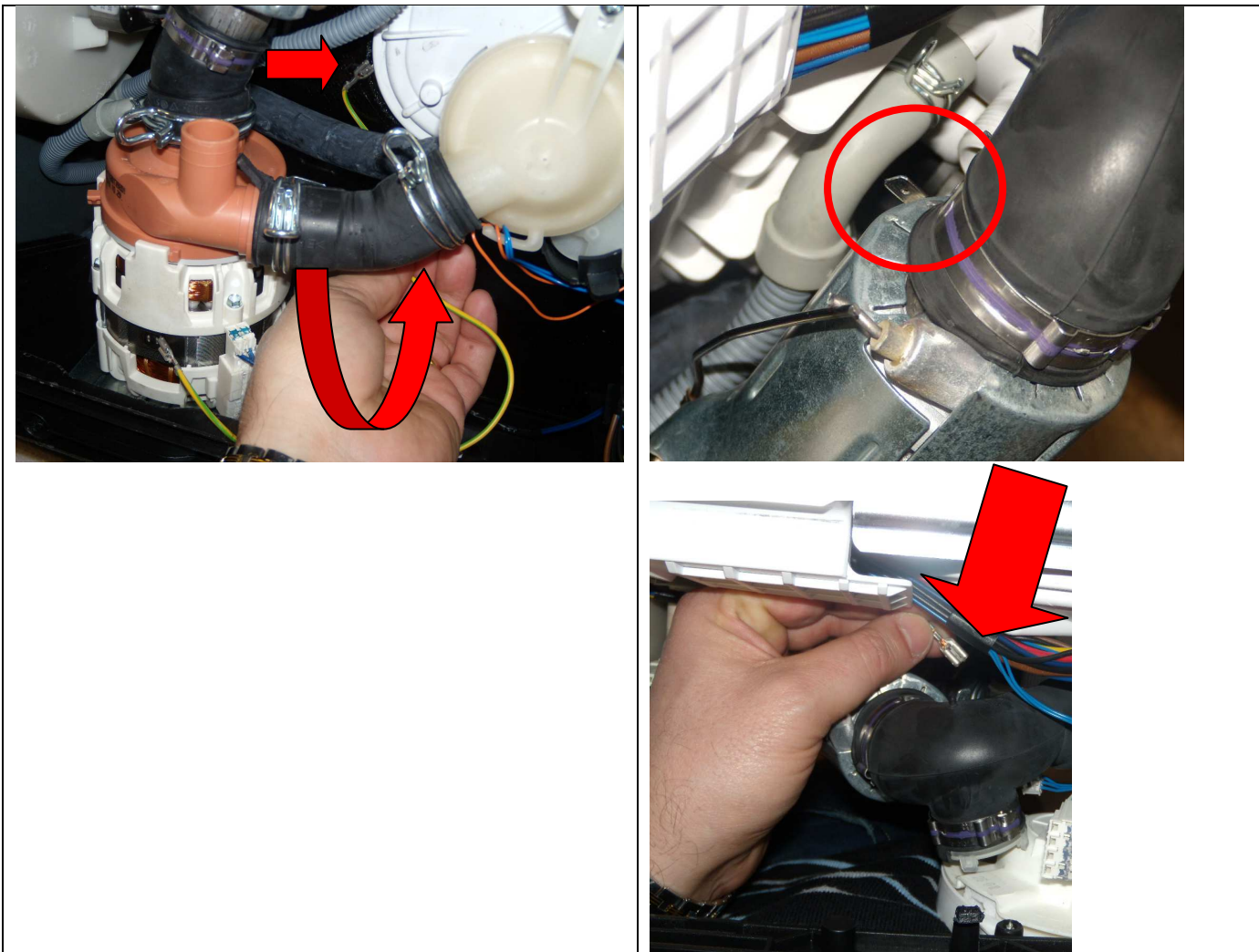

Caution !!!!! the cable must be passed through the ducts provided and must not touch the heating element