

Control Knob Conversion Kits to fit early Chef/Major motors

651445 White 651449 Black

This kit is supplied to convert the bezel style control knobs, 608735 and 615491, which are No Longer Available.

Parts 602494, 608773, 608761, 615489, and 602511, are still available While Stocks La

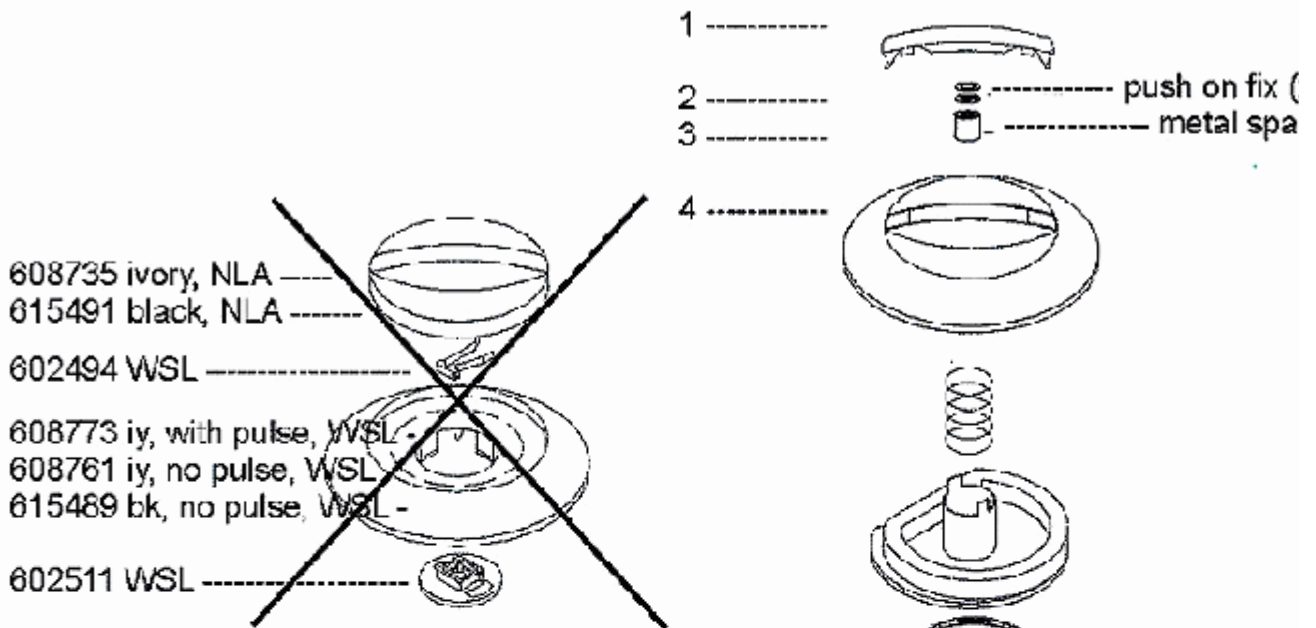

FIGURE 1

parts in Figure 1 were fitted to models:

KM201 - KM210 - KM230 (Ivory)
 KM220 (Black)

parts in Figure 2 were fitted to models:

KM200 - KM230 (White)
 KM220 - KM250 (Black)

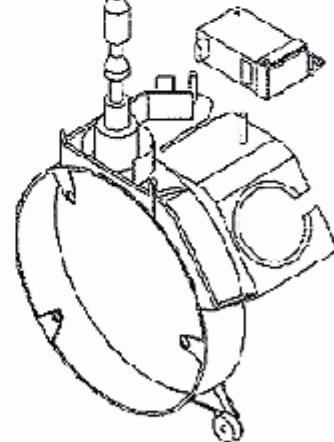

FIGURE 2

Procedure for Conversion:

- The contents of this kit are parts numbered 1-4 only
- Replace all parts shown in Figure 1 with parts 1-4, in the following order.
- Place the control knob onto the shaft followed by the metal spacer
- Secure these by gently tapping a push-on-fix onto the shaft until it sits against the metal
- Repeat this operation with the second push-on-fix
- Fit the control knob insert
- Figure 2 shows the order in which the components are fitted